

APM

CLIENT

Gonzaga College High School
Father Allen Novotny, S.J.
Phone: 202.336.7171

ARCHITECT (THEATER RENOVATION)

Geier Brown Renfrow Architects
Mr. Bill Geier
703.836.9775

ARCHITECT

Cox Graae + Spack Architects
Mr. Chris Graae
Phone: 202.965.7070

GENERAL CONTRACTOR

TBD

\$15.8 MILLION MASTER BUDGET

**9 MONTHS OF CONSTRUCTION
39,000 GSF**

**(30,500 RENOVATIONS AND NEW
CONSTRUCTION 8,284 SF)**

LEED OBJECTIVE: SILVER

**THEATER RENOVATION USING
STATE-OF-THE ART TECHNOLOGY,
THEATER SUPPORT BUILDING ADDITION,
WEST CARMODY AUXILIARY GYM
ADDITION, EXISTING GYM RENOVATIONS,
DOOLEY LOWER LEVEL RENOVATIONS**



Gonzaga College High School, West Campus Expansion Phase Washington, D.C.

Gonzaga College High School, the oldest educational institution in the old Federal City of Washington, is located on a 15-acre site in the heart of Washington DC.

- **THEATER RENOVATION:** A major factor is incorporating the use of state-of-the-art technology, yet preserves the Victorian look and feel of this historic theater. The front entrance area will be enhanced with new front doors, directional lighting, construction of a ticket booth, and acoustical finishes. New lighted signage will be installed in front of the theater entrance, enhancing the building for evening events. The Theater will include 5 additional ADA seating locations in addition to 594 seats on the main level; and 380 seats on the balcony level. A new covered porch and walk will be added to provide connectivity to the Kohlmann and wheelchair access to the stage via the theater support building. A large overhead rolling door will connect the theater stage to the new work shop in the Theater Support Building to facilitate set construction and erection. The stage will be restored to its original size and an orchestra pit will be created at floor level in front of the stage. New stage equipment will include: a new stage floor, curtains, rigging, line sets and battens. The stage lighting will be relocated and additional lighting added to the front and side areas with a dimming system. The rear balcony area will receive a new projection, lighting, and sound booth. The radiators will be replaced with a modern heating & air conditioning system, and the sprinkler system will be extended within Theater Building.



Renderings by Geier Brown Renfrow Architects

- **DOOLEY LOWER LEVEL RENOVATION:** Interior renovations will be completed within the summer break. The existing Football/Lacrosse locker rooms will be modified to support additional lockers and improvements to the sports training room. The existing historic Dooley Gym will be renovated to create a new weight training room, with new lighting, HVAC systems, and general building code improvements.



- **DOOLEY BASEMENT LEVEL ERGONOMICS:** Renovation of the existing Dooley Gym basement into a space for Ergonomics equipment.

APM

“Gonzaga College High School and APM have enjoyed a fruitful relationship for over 10 years.”

2008 - (Rev.) Allen P. Novotny,
S.J., *Past President*
Gonzaga College High School

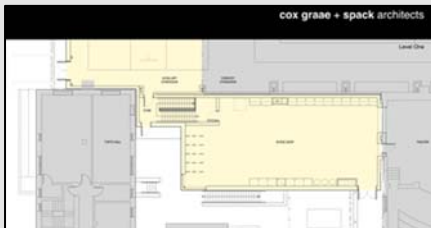
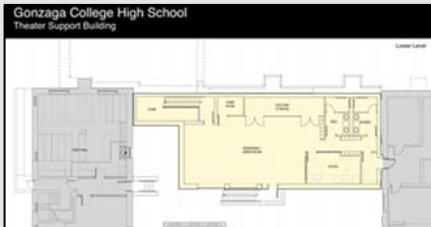

Graphics by Cox Graae + Spack Architects

Gonzaga College High School, West Campus Expansion Phase Con't.

- **THEATER SUPPORT BUILDING:** This two-story addition includes a covered connector and egress porch. The TSB is a new home for the Theater program, including a green room and rehearsal space, costume storage, office, lockers, restrooms, and scene shop. While the roof provides support for multiple new air handling units that provide modern conditioning with the Theater Building, new electrical systems for the Theater will be also be housed within the TSB. Surrounded by structures on all side the constricted site for the new addition is the project's biggest challenge. In addition to advance work to make way for the support building, the project will also include underpinning of adjacent Carmody Building foundations and sheeting & shoring to maintain operational HVAC units and egress corridors for adjacent buildings.
- **KOHLMANN ELECTRICAL ROOM AND ELECTRICAL UTILITY INSTALLATION:** An existing room within the Lower Level of the Kohlmann Building will be vacated and repurposed to a new electrical service room housing new switchgear serving the buildings on the west side of campus, providing ample capacity for the future East Academics & Athletics Addition. Particular challenges include coordination of the installation of the electrical service transformer vault with utilities in the Eye Street utility easement.
- **COURTYARD HVAC RELOCATIONS & DEMOLITION:** To make room for construction of the new Theater Support Building additions, existing HVAC package units and ventilation systems serving the existing cafeteria in the basement of the Theater Building will be relocated within the courtyard. This work includes installation of temporary support structures and temporary installation of cafeteria ventilation equipment, which will be installed on the roof of the new Theater Support Building after its completion. The demolition of a small wing of the existing Carmody Gymnasium building will be demolished to clear the footprint of the Theater Support Building.
- **EXISTING GYM RENOVATION:** Renovations include EIFS and pre-finished metal panels at rear building façade, roof replacement, new lighting, and HVAC and AV systems. New HVAC systems will be located on top of Auxiliary Gym Addition. The existing gym floor and bleachers will be protected throughout the renovation and structural reinforcement will be added to the existing gym roof structure to support of a new HVAC unit supplying air conditioning to the east side of the Theater Renovation.
- **WEST CARMODY AUXILIARY GYM ADDITION:** The one-story addition to the gym box includes an extensive green roof, practice court, batting cage and other gym equipment. Packaged HVAC units for both the Auxiliary Gym and the Existing Gym are supported on the roof of the addition. Due to the need to deliver the Existing Gym Renovation in time for Basketball Season, the construction of the Auxiliary Gym will include a temporary partition.
- **FORTE HALL RENOVATIONS:** Architectural modifications to the Lower Level of Forte Hall create a new egress corridor from the existing Courtyard to the alley to the west of Forte, while providing a new location for Gonzaga's award winning rowing team to practice.

